

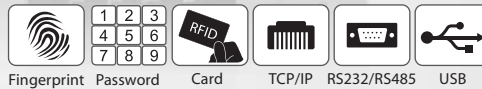

## Time to color your presence with **Q2i & TA200 Plus**

Fingerprint Color Time Attendance  
& Door Access System



FingerTec's Q2i & TA200 Plus are astounding hi-tech fingerprint time attendance and door access devices with an impressive design. With an exceptional storage capacity and equipped with the latest precision fingerprint scanning algorithm, the Q2i & TA200 Plus give you some amazing and convenient features such as work codes and short message display for either personal or public recipients for effective staff communication. The terminals also come with many options and methods for you to sync your terminal to the bundled software, FingerTec's TCMS V2 for further processing of attendance data to ease report generating and payroll processes.

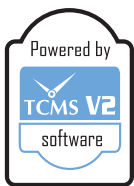

### A Variety of Verification Methods

Although its recommended that you use fingerprint verification for more authentic attendance and access control functions, the terminal also offer options for you to verify using a card or password, or even a combination of the two!



### Shortcut Keys

Program these keys to take you to commonly used functions in just one step. Did we mention that we make things easy?

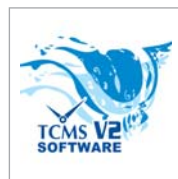

### Manage Your Data Easily

Administration is easy with the bundled software! FingerTec's TCMS software allows you to generate reports, monitor attendance and integrate FingerTec with a third party system



### Easy Terminal Syncing

With the option of TCP/IP, RS485 / RS232, USB flashdisk, or even WiFi (upon request), syncing your terminal is even easier than you think!



### Supersized Capacity

Get up to 10000 fingerprint templates and 200000 transaction logs – more than enough to fulfill the requirements of an SME.



### Built-In Alarm

Increase the security at your workplace by installing an external alarm, and be alerted during unexpected scenarios such as break-ins and fire emergencies.



### Workcodes

Let your staff experience more independence by reporting their whereabouts via our workcodes feature.



### Full Colour Screen

This model comes with a full colour TFT screen. Display pictures corporate advertisements, screen savers and much more on the colour screen of the terminals.

## WEB LINK

### Product

- <http://info.fingertec.com/q2i-1>
- <http://info.fingertec.com/ta200p-1>

### Quick Start Guide

- <http://info.fingertec.com/q2i-2>
- <http://info.fingertec.com/ta200p-2>

### Installation Guide

- <http://info.fingertec.com/q2i-3>
- <http://info.fingertec.com/ta200p-3>

### User Guide

- <http://info.fingertec.com/q2i-4>
- <http://info.fingertec.com/ta200p-4>

### Video Guide

- <http://info.fingertec.com/q2i-5>
- <http://info.fingertec.com/ta200p-5>

### Technical Tips

- <http://info.fingertec.com/q2i-6>
- <http://info.fingertec.com/ta200p-6>



### Packaging

- Q2i (Door Access & Time Attendance)**  
Dimension (mm) : 245(L) x 90(W) x 225(H)  
Weight : 1.8kg
- TA200 Plus (Time Attendance only)**  
Dimension (mm) : 245(L) x 90(W) x 225(H)  
Weight : 1.3kg

## LAYOUT PLAN

### System Communication

for illustration only

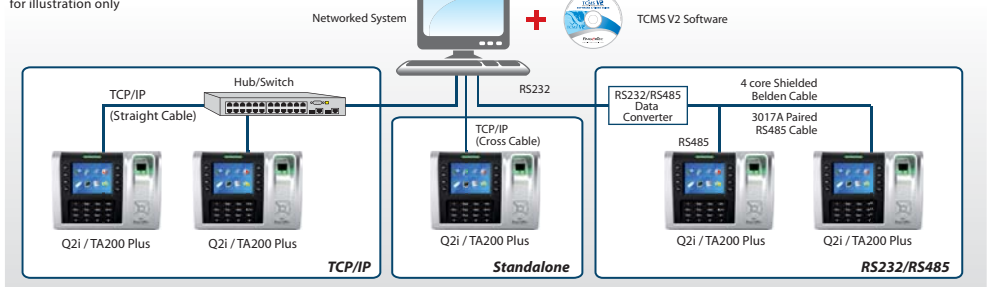

### Installation Diagram (for Q2i only)

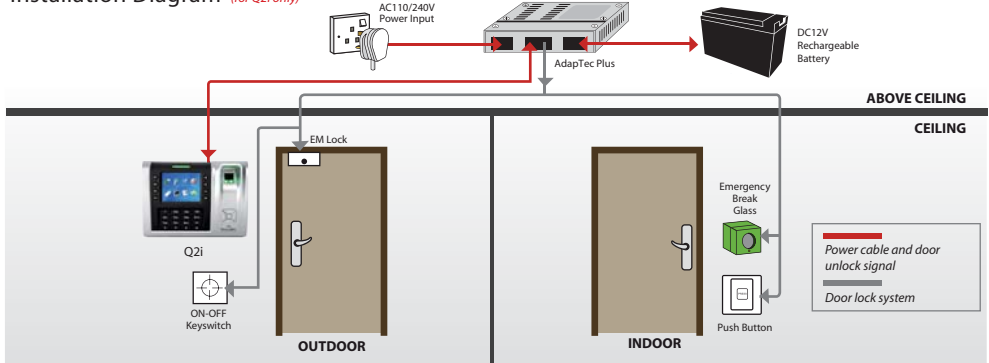

## SPECIFICATIONS

MODEL	Q2i	TA200 Plus
<b>SURFACE FINISHING</b>	Acrylonitrile Butadiene Styrene (ABS)	
<b>TYPE OF SCANNER</b>	Optical	
<b>PROCESSOR</b>	400 MHz microprocessor	
<b>MEMORY</b>	256MB flash memory	
<b>ALGORITHM</b>	BioBridge VX 9.0 / VX 10.0	
<b>PRODUCT DIMENSION (L X W X H), mm</b>	200 x 56 x 160	
<b>STORAGE</b>		
• Fingerprint templates	10000	
• Transaction	200000	
<b>ENROLLMENT &amp; VERIFICATION</b>		
• Methods	Fingerprint (1:1, 1:N), Card & Password	
• Recommended Fingerprint per user ID	2	
• Fingerprint placement	Any angle	
• Verification time (sec)	< 1	
• FAR (%)	< 0.0001	
• FRR (%)	< 1	
<b>CARD TECHNOLOGY</b>		
• RFID: 64-bit, 125kHz	Yes	
• MIFARE: MF1S50/S70, 13.56MHz	Made to order	
• HID: HID 1325, 26-bit, 125kHz	Made to order	
<b>COMMUNICATIONS</b>		
• Method	TCP/IP, RS232, RS485, USB flash disk (Optional WiFi)	TCP/IP, USB flash disk, POE (Optional RS232, RS485, WiFi)
• Baud rates	9600, 19200, 38400, 57600, 115200	
• Wiegand	26-bit input/output	N/A
<b>OPERATING ENVIRONMENT</b>		
• Temperature (°C)	0 ~ 45	
• Humidity (%)	20 ~ 80	
• Power input	DC12V 3A	
<b>TIME ATTENDANCE</b>		
• Siren	Built-in (Optional - External)	
• Work codes	Yes	
<b>MULTIMEDIA</b>		
• Voice	Yes	
• Display	3.5" 65k color TFT screen	
• Short messaging	Yes	
<b>ACCESS CONTROL</b>		
• EM lock driving output	DC12V 3A / Relay output	N/A
• Alarm output	NO / NC	N/A
• Antipassback	Yes	N/A
<b>VOICE / DISPLAY LANGUAGE (TERMINAL)</b>	English (Standard) / Other languages are available upon request.	
<b>SOFTWARE LANGUAGE</b>	English, Arabic, Malay, Indonesian, Chinese (Traditional), Chinese (Simplified), Thai, Spanish, Portuguese (Brazil), Polish, Vietnamese, French, Russian, Persian, German, Italian, Turkish	

\*N/A: Not applicable

Authorized Reseller:



**FINGERTEC**  
www.fingertec.com

©2012 FingerTec Worldwide Sdn. Bhd. All rights reserved.